

Newhall Bike Path & Retaining Wall

Meet the Team



Suriya Laiq
Project Manager



Zohra Kushkaki
Structural Engineer



Yara Metlak
Geotechnical Engineer



Rezeq Khalifeh
Construction Engineer



Laura Barney-Munoz
Environment Engineer



Daniel Langstraat
Transportation Engineer



Derian Theberge
Civil Engineer

Design

Background: Located in Santa Clarita, this project entails expanding on an existing bike path and adding a retaining wall to the side.

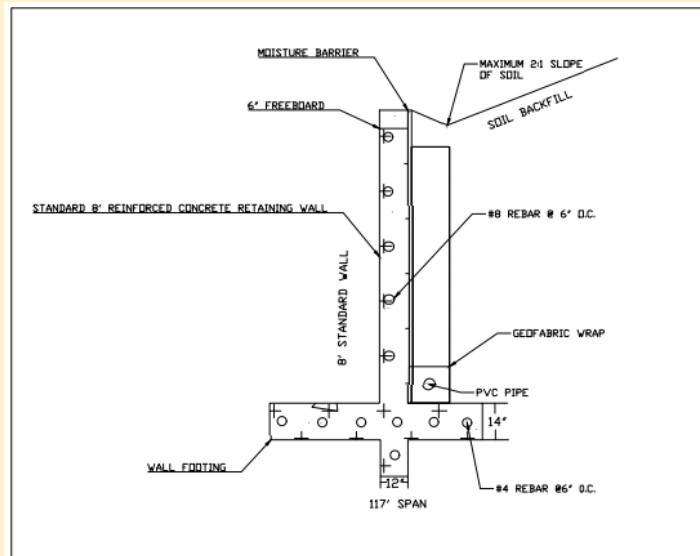

Retaining Wall: Reinforced concrete with #8 bars at 6" O.C. are used here. This is an 8' standard wall with a 117' span.

Bike Path Design:

First, a traffic control plan is set in place to account for path blockage and subsequent path expansion.



Additional Considerations: Further information regarding hydrology, cost estimates, geotechnical reports, and environmental findings are presented in the full report.